

John Nicholson
No 1139

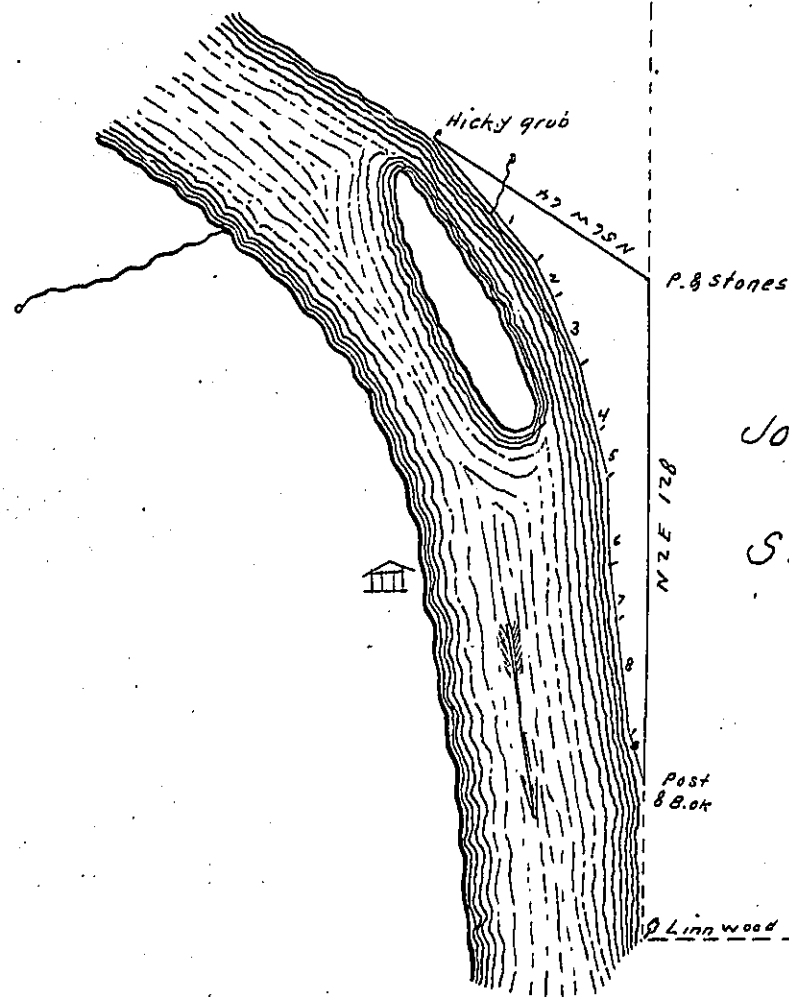

Courses and distances down the river from Hickory grub on Beach. VIZ.

- N. 1. S 39 3/4 E 39 1/2
- 2. S 22 1/2 E 9 1/2
- 3. S 21 E 20
- 4. S 10 E 11 1/2
- 5. S 12 E 16
- 6. S 1 W 22
- 7. S 1 1/2 E 14
- 8. S 6 1/2 E 29
- 9. S 9 E 12 1/2

John Nicholson
No 1140 now
S. J. Nicklin

Draft of a lot of land situate in Cranberry Township, Venango County, East of and adjoining the Allegheny River and containing Nine acres, fifty three perches and Alls. &c.
Survey'd April 2^d 1860 in pursuance of a Warrant granted to Richard Irwin dated 6th January A. D. 1860.

Hon. John Rowe } Wth Hilonds
Surveyor General } C. S.

IN TESTIMONY that the above is a copy of the original remaining on file in the Department of Internal Affairs of Pennsylvania, made conformably to an Act of Assembly approved the 16th day of February, 1833, I have hereunto set my Hand and caused the Seal of said Department to be affixed at Harrisburg, this seventeenth day of June 1905.

Isaac R. Brown
Secretary of Internal Affairs.